

# Printed-circuit board connector - MCV 0,5/15-G-2,54 SMDR72C2 - 1706077

Please be informed that the data shown in this PDF Document is generated from our Online Catalog. Please find the complete data in the user's documentation. Our General Terms of Use for Downloads are valid (<http://phoenixcontact.com/download>)

PCB headers, nominal current: 6 A, rated voltage (III/2): 160 V, number of positions: 15, pitch: 2.54 mm, color: black, contact surface: Gold, mounting: SMD soldering, Fixed coding of the last position, can be combined with the FMC 0,5/...-ST-2,54 C2 connector



The figure shows the 10-position version

## Why buy this product

- Designed for integration into the SMT soldering process
- Additional solder anchors reduce the mechanical strain on the soldering spots
- Gold-plated contacts ensure transfer quality remains stable over the long term
- Vertical connection enables multi-row arrangement on the PCB
- Supplied in tape-on-reel packing according to IEC 60286-3 for automated mounting



## Key Commercial Data

|                        |               |
|------------------------|---------------|
| Packing unit           | 315 STK       |
| Minimum order quantity | 315 STK       |
| GTIN                   |               |
| GTIN                   | 4046356842587 |

## Technical data

### Dimensions

|                |                |
|----------------|----------------|
| Length [ l ]   | 4.8 mm         |
| Width          | 42.64 mm       |
| Pitch          | 2.54 mm        |
| Dimension a    | 35.56 mm       |
| Width [ w ]    | 42.64 mm       |
| Height [ h ]   | 7.1 mm         |
| Pin dimensions | 0.64 x 0.64 mm |
| Length         | 4.8 mm         |

# Printed-circuit board connector - MCV 0,5/15-G-2,54 SMDR72C2 - 1706077

## Technical data

### General

|  |                   |
|--|-------------------|
| Range of articles                      | MCV 0,5/...-G-SMD |
| Insulating material group              | IIIa              |
| Rated surge voltage (III/3)            | 2.5 kV            |
| Rated surge voltage (III/2)            | 2.5 kV            |
| Rated surge voltage (II/2)             | 2.5 kV            |
| Rated voltage (III/3)                  | 32 V              |
| Rated voltage (III/2)                  | 160 V             |
| Rated voltage (II/2)                   | 160 V             |
| Connection in acc. with standard       | EN-VDE            |
| Nominal current $I_N$                  | 6 A               |
| Insulating material                    | LCP               |
| Flammability rating according to UL 94 | V0                |
| Color                                  | black             |
| Number of positions                    | 15                |

### Standards and Regulations

|  |        |
|--|--------|
| Connection in acc. with standard       | EN-VDE |
| Flammability rating according to UL 94 | V0     |

### Environmental Product Compliance

|            |   |
|------------|---|
| China RoHS | Environmentally friendly use period: unlimited = EFUP-e |
|            | No hazardous substances above threshold values          |

## Drawings

Drilling diagram

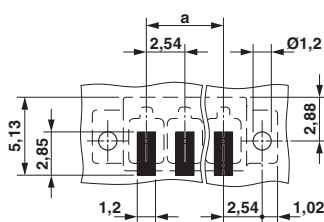

Dimensional drawing

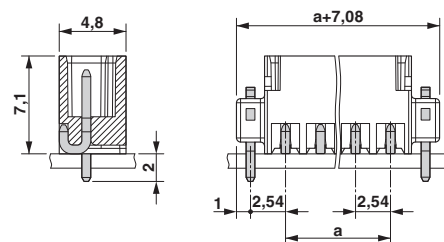

## Approvals

### Approvals

### Approvals

cULus Recognized / VDE Gutachten mit Fertigungsüberwachung / IECCE CB Scheme / EAC

# Printed-circuit board connector - MCV 0,5/15-G-2,54 SMDR72C2 - 1706077

## Approvals

Ex Approvals

### Approval details

|                    |  |   |                 |
|--------------------|--|---|-----------------|
| cULus Recognized   |  | <a href="http://database.ul.com/cgi-bin/XYV/template/LISEXT/1FRAME/index.htm">http://database.ul.com/cgi-bin/XYV/template/LISEXT/1FRAME/index.htm</a> | E60425-19920306 |
|                    |  | B   | C               |
| Nominal voltage UN |  | 150 V   | 50 V            |
| Nominal current IN |  | 6 A   | 6 A             |

|  |  |  |          |
|--|--|--|----------|
| VDE Gutachten mit<br>Fertigungsüberwachung |  | <a href="http://www2.vde.com/de/Institut/Online-Service/VDE-gepruefteProdukte/Seiten/Online-Suche.aspx">http://www2.vde.com/de/Institut/Online-Service/<br/>VDE-gepruefteProdukte/Seiten/Online-Suche.aspx</a> | 40042258 |
|  |  |  |          |
| Nominal voltage UN                         |  | 160 V  |          |
| Nominal current IN                         |  | 6 A  |          |

|                    |  |   |              |
|--------------------|--|---|--------------|
| IECEE CB Scheme    |  | <a href="http://www.iecee.org/">http://www.iecee.org/</a> | DE1-55663-B1 |
|                    |  |   |              |
| Nominal voltage UN |  | 160 V   |              |
| Nominal current IN |  | 6 A   |              |

|     |  |  |         |
|-----|--|--|---------|
| EAC |  |  | B.01742 |
|-----|--|--|---------|

Phoenix Contact 2018 © - all rights reserved  
<http://www.phoenixcontact.com>

PHOENIX CONTACT GmbH & Co. KG  
Flachsmarktstr. 8  
32825 Blomberg  
Germany  
Tel. +49 5235 300  
Fax +49 5235 3 41200  
<http://www.phoenixcontact.com>